

BLRT33

LED Recessed Troffer



Project	
Nomenclature	
Type	Date
Approval	
Notes	

The BLRT33 is a recessed lay-in fixture designed for use in metric T-bar ceilings and is well suited for use in office spaces where a clean, professional, 30x30 footprint is required

Luminaire Summary

Features

- Operating temperature ranges available from -20C to 25C
- L70 of 150,000+ hours, L90 of 45,000+ hours
- Standard 0 - 10V dimming
- Available in 2700K, 3000K, 3500K, 4000K, 5000K and 6500K

Approvals

- ETL certified to UL Canada and United States standards
- Made with UL Listed components

Mounting

- Holes provided for chain or hanger, and wire mounting support for T-Bar ceilings

Construction

- Manufactured in Ontario, Canada
- Shallow fixture design for easy installation
- Powder-coated in matte white
- Access panel provided for easy wiring
- Cold-rolled steel parts are precision bent for added strength and rigidity

Electrical

- Available in 120-277V, 120-347V, 347V and 480V

Options

- Wireless Controls Available
- 90 and 95+ CRI Options Available
- 120-347V(UN3) Available
- Passive/Active Air Handling Available

BLRT33

LED Recessed Troffer | Nomenclature



Ordering Information

Fill in the fields below with your product selections. If you need help with this section, [contact your local sales professional](#).

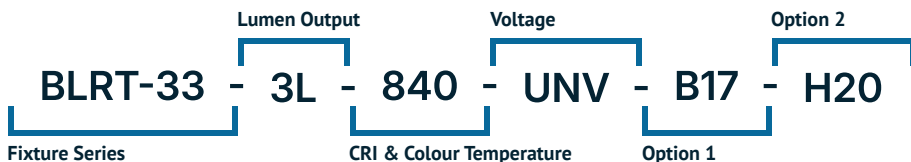

1	2	3	4	5
BLRT33				

Series	Size & Lumen Output	CRI	Colour Temp	Voltage
BLRT33	30x30 - 2L (1989 lm)	8 - 80 CRI	27 - 2700K	UNV - 120-277V
	30x30 - 2.5L (2483 lm)	9 - 90 CRI	30 - 3000K	UN3 - 120-347V
	30x30 - 3L (2975 lm)	1 - 95+ CRI	35 - 3500K	347 - 347V
	30x30 - 3.5L (3465 lm)		40 - 4000K	480 - 480V
	30x30 - 4L (3954 lm)		50 - 5000K	
	30x30 - 4.5L (4441 lm)		65 - 6500K	
	30x30 - 5L (4927 lm)			

6

Options

Lenses

BLANK | Frosted Acrylic

Dimming

B11 | 0-10V Dimming Leads

B12 | Line Voltage Dimming

B27 | Dim-to-off Driver

B** | Other Options Available*

Controls

WC10* | Encelium Wireless Controls

WC18* | NX Wireless Controls

WC19* | Avi-on Wireless Controls

WC22* | JDRF Wireless Controls

Motion Sensors

WX15 | Internal Dimming Low Voltage Microwave Sensor

WC20 | Leviton Low-Voltage Sensor

W** | Other Options Available*

Emergency Driver

B17 | UL924 10W Battery Back-up

F8 | UL924 Emergency Relay

Air Handling

H20 | Housing with Passive Air Handling

H24 | Housing with Active Air Handling

Finish

BLANK | Standard Matte White

C5 | Matte Black

CUSTOM* | Custom Colour Choice

Packaging

BLANK | Individually Boxed on Pallets

P0 | Bulk Packaging

P** | Other Options Available*

Mounting

BLANK | Metric Recessed

Warranty

CL7 | 10-Year Comprehensive Warranty Upgrade

Documentation and Resources





All files and resources are available on our website for download. Files and resources are also embedded as links in this document, listed below. Additional files may be available upon request. Please contact your local sales agent [here](#) or contact sales@bjtake.com for more information.

 BLRT-33-3L-840

 BLR-33-4L-840-H20

Certifications and Listings

Certifications that apply to this fixture and its possible configurations are listed here. More information available upon request.

Icon	Description
	Wireless Controls Available
	ETL Listed
	90 and 95+ CRI Options Available
	120-347V(UN3) Available

Usage Applications

This fixture can be used in a variety of applications, and is ideal for the following:

Usage Application
Hospitals
Offices
Schools

Warranty Statement

BJ Take products are tested and/or inspected prior to being packaged for shipment and are guaranteed from the day the product is shipped for a period of ten-year LED chip warranty and a five-year comprehensive component warranty. This can be upgraded to a ten-year comprehensive warranty on request.

BLRT33

LED Recessed Troffer | Dimensions & Wattage

BLRT Metric 30x30, Side Dims

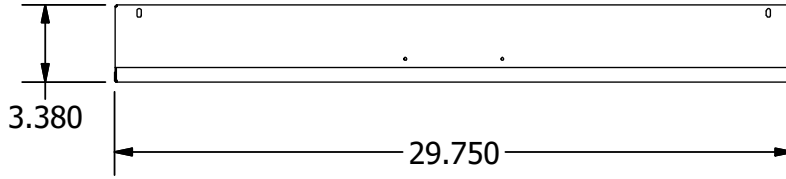

Isometric Top View

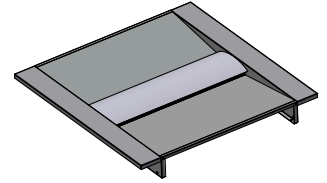

BLRT Metric 30x30, Side Dims

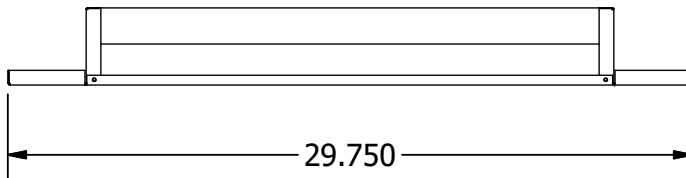

Isometric Top View

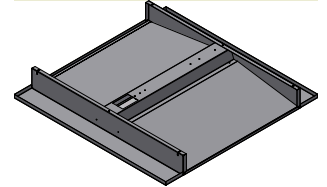

BLRT, Metric 30x30 Wattage

Size	Lumen Output	Actual Lumen Output	Wattage
30x30	2L	1989	14.80
30x30	2.5L	2483	18.40
30x30	3L	2975	22.10
30x30	3.5L	3465	25.80
30x30	4L	3954	29.50
30x30	4.5L	4441	33.20
30x30	5L	4927	36.80

BLRT, Light Loss Factor (LLF)

CCT	Output%
2700K	92.95
3000K	95.51
3500K	96.80
4000K	100.00
5000K	101.28
90CRI	84.72

- * Drawings aren't to scale
- * Standard tolerances apply
- * Specifications may change without notice

BLRT33

LED Recessed Troffer | Photometrics

BLRT-33-3L-840

Cone of Light

Mtg Height	Light Level	Beam Diameter
6.0 ft	27.5 fc	16.3 ft
8.0 ft	15.5 fc	21.7 ft
10.0 ft	9.9 fc	27.2 ft
12.0 ft	6.9 fc	32.6 ft
14.0 ft	5.0 fc	38.0 ft
16.0 ft	3.9 fc	43.5 ft

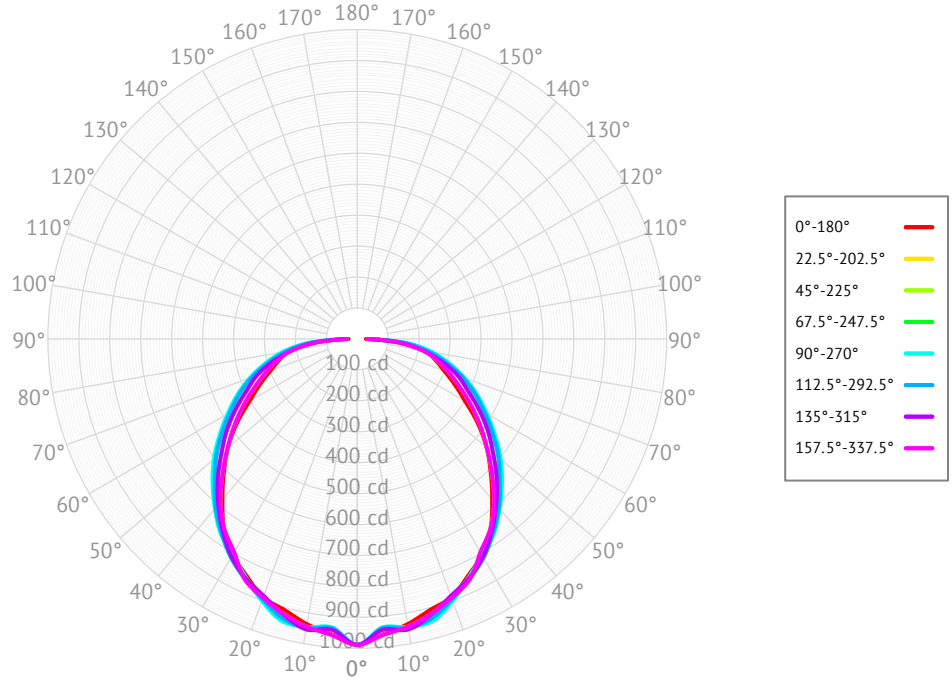

Based on BLRT-33-3L-840, ie. (BLRT, 30x30 Metric, 3000lm, 80 CRI, 4000K)

BLRT-33-4L-840-H20

Cone of Light

Mtg Height	Light Level	Beam Diameter
6.0 ft	35.9 fc	16.0 ft
8.0 ft	20.2 fc	21.3 ft
10.0 ft	12.9 fc	26.6 ft
12.0 ft	9.0 fc	32.0 ft
14.0 ft	6.6 fc	37.3 ft
16.0 ft	5.1 fc	42.6 ft

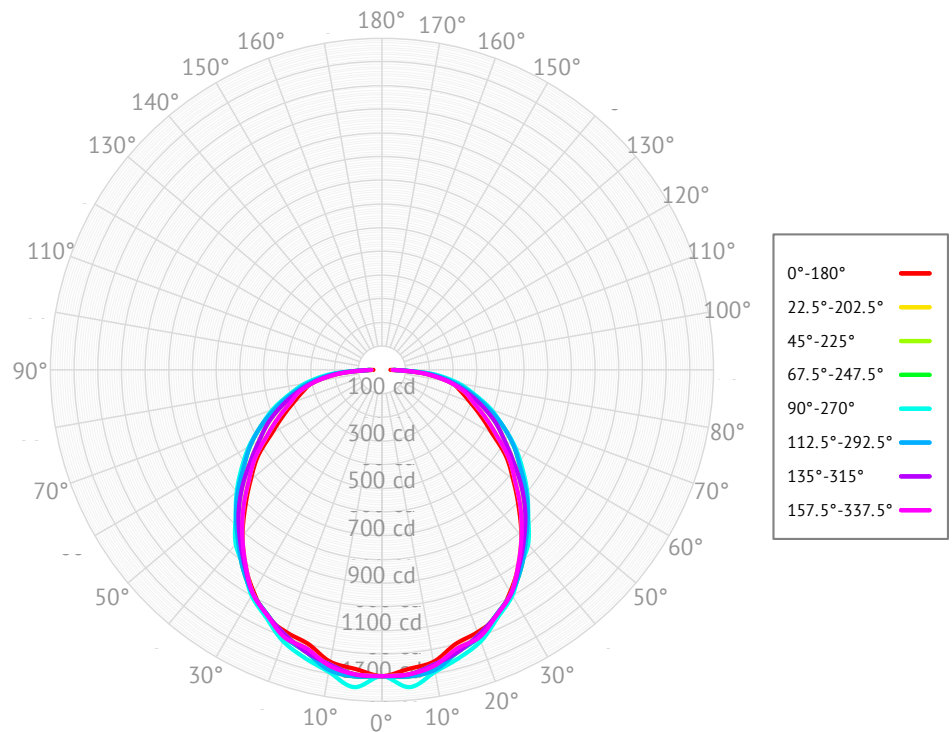

Based on BLRT-33-4L-840-H20, ie. (BLRT, 30x30 Metric, 4000lm, 80 CRI, 4000K w/ Passive Air Handling)

BLRT33

LED Recessed Troffer | Emergency Lighting



Emergency Battery Plan - 10W

Emergency Lighting	Solution System Components	System Operation
Option Code 'B17' - UL 924 listed components that are factory installed in the luminaire	UL 924 listed 10-watt battery integral to the luminaire	Loss of normal power is detected by the B17 emergency light solution and the power supply is switched automatically to the 10-watt integral battery pack which powers the emergency LED lighting driver.
	UL 924 listed LED emergency lighting driver integral to the luminaire	The battery pack and emergency LED driver are UL 924 certified to provide a minimum of 90-minutes of emergency lighting.
	Wiring options for both switched and unswitched emergency lighting	

Emergency Lighting Wiring

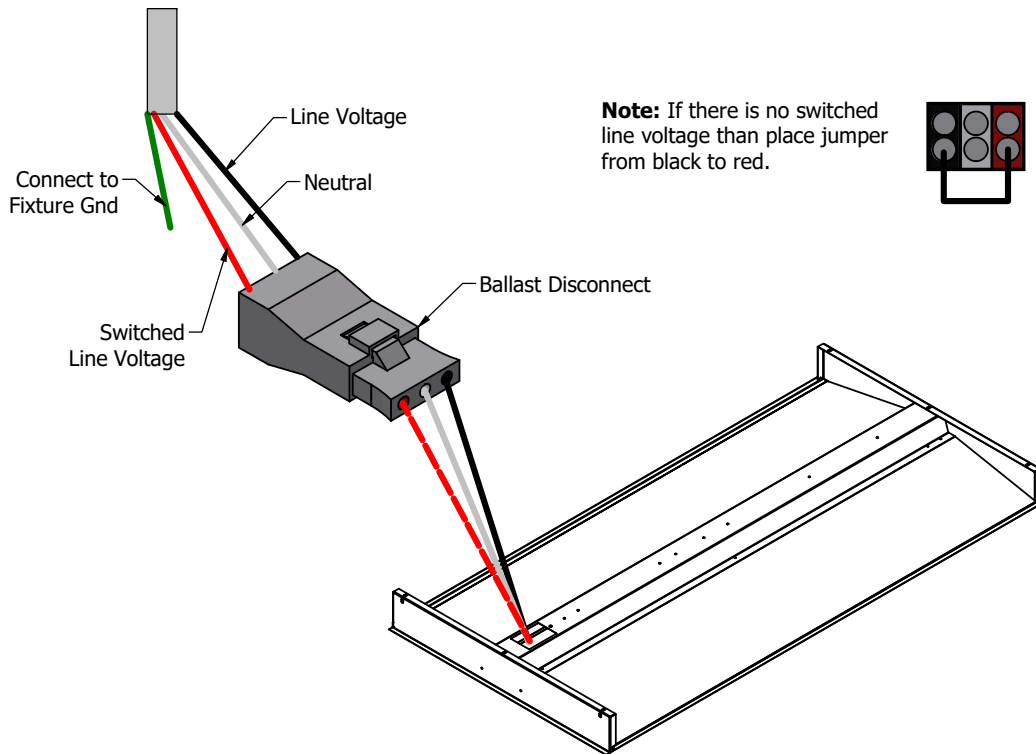

Important Information

More information on emergency lighting options and configurations available on request.